

# OLD GROWTH CLASSIFICATION

## STAND LOCATION AND SKETCH

Location / Site Number Plot 186 - Hermosa - ~~main~~ trail  
stock

Project Name / Unit Number \_\_\_\_\_

Plot Spacing: \_\_\_\_\_ Meters by \_\_\_\_\_ Meters

Reference Point Description: \_\_\_\_\_

Travel Route to Reference Point: from 185

SEC. \_\_\_\_\_ T. \_\_\_\_\_ R. \_\_\_\_\_ USGS 7.5 min. Quad

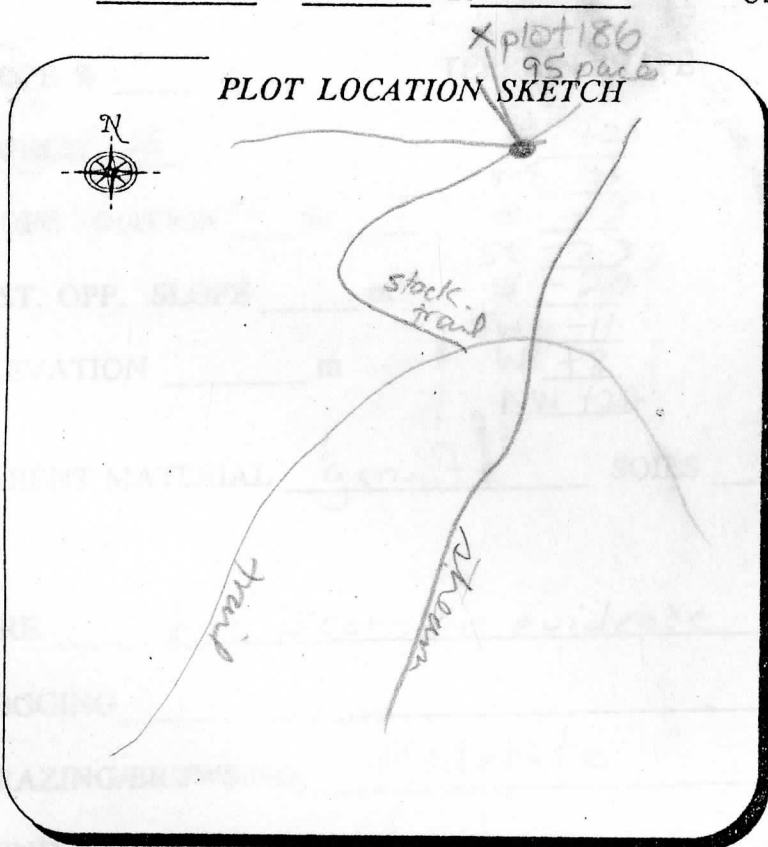

come down trail to stream - w/o bridge  
- 10 paces back up trail 10 paces and  
take cattle trail to N - up 95 paces

From	To	AZ	DIST.	Corrections

	Road, Improved
	Road, logging
	Trail
	Drainage, Intermittent
	Ridge
	Fence
	Cattleguard
	Reference Point (RP)
	Supplemental RP
	Plot Location Center
	Direction of Travel
	Point and Point Number
	Azimuth
	Chains

is a large Pipu  
and another  
trail merges - go  
paces upslope (N)