

STAND LOCATION AND SKETCH

Project Name / Unit Number

Reference Point Description :

SEC. _____ T. _____ R. _____

USGS 7.5 min. Quad

7.5 min. Quad
approx - 2080 from 229 toward 230
cont. down ravine and on left
~80m

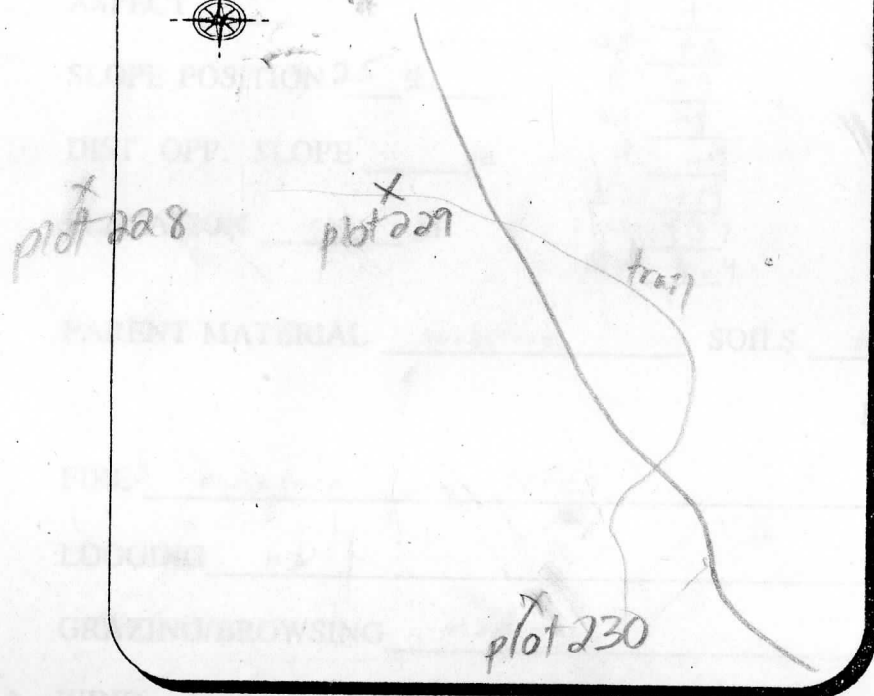
[illegible]

- | | |
|-------|------------------------|
| | Road, Improved |
| | Road, logging |
| | Trail |
| | Drainage, Intermittent |
| | Ridge |
| | Fence |
| | Cattleguard |
| ⊙ RP | Reference Point (RP) |
| ⊙ SRP | Supplemental RP |
| ⊙ PC | Plot Location Center |
| | Direction of Travel |
| • 3 | Point and Point Number |
| 97° | Azimuth |
| CH | Chains |